

## Landscape Addendum

## Addendum #: 03

To:	Prospective Contractors	From:	Zoe Wimmer
Company Name:	O2 Planning + Design	Date:	2022-03-11
Contact:	zoe.wimmer@o2design.com	Enclosures:	Schedule B – Schedule of Quantities, G-001, LM-101, LM-500, LM-502, Section 01 53 00 – Temporary Construction
Project Name:	Drumheller Downtown Plaza	O2 Project No.:	210201
Addendum Name:	Addendum 3		

### DESCRIPTION

Landscape addendum capturing a variety of clarifications to drawings.

#### **Schedule B – Schedule of Quantities**

##### 1. Schedule 1 – General Conditions

- Item 1.2 updated to clarify the inclusion of a Building Permit, no development permit is required.

##### 2. Schedule 2 – Selective Demolition and Relocation

- Addition of Item 2.10, relocation of existing grease, recycling and garbage bins from existing spot on site to new location within new waste enclosure.

##### 3. Schedule 4 – Hardscape

- Item 4.5 – Standard Curb and Gutter Unit of Measurement revised from m2 to l.m.
- Item 4.7, flush header at drive aisle removed, replaced with increased quantities of Item 4.3 (Concrete Paving – Heavy Duty), to capture curb letdown.

##### 4. Schedule 7 – Stage

- Revision of Item 7.1 Unit of Measurement from m2 to Lump sum.

##### 5. Schedule 9 – Electrical

- Item 9.1 Unit of Measure revised from ea. to ls. Quantity revised.

#### **Drawings**

##### 6. G-001

- Materials Schedule Updated

##### 7. LM-101

- Item 4.08 has been removed from the schedule, remove 15.4 lm. Add of 4.2m2 to 4-03 (Concrete Paving – Heavy Duty) in its place to encapsule the curb letdown at drive aisle.
- Schedule updated. Items 4-02 + 4-03 descriptions have been updated to indicate control and expansion joint spacing.

8. LM-500

- Details 7, 8, 9 & 12 have been updated to include rebar specifications and dimensions.

9. LM-502

- Details 5 + 6 updated to include additional mid-span posts in waste enclosure details.

**Specifications**

10. Section 01 53 00 – Temporary Construction

- Item 1.4 removed. There is no longer a requirement for a temporary site enclosure

**Notes**

11. Electrical

- Drawing E2.4 Equipment Schedule Item E9: Alternate make/model are as follows:  
Make: Lafarge / Model: 9203  
Make: Proform / Model: LP2134

12. Landscape

END OF ADDENDUM

Project Title: DRUMHELLER DOWNTOWN PLAZA  
 Schedule B - SCHEDULE OF QUANTITIES  
 RFP 2022-02-15 - Addendum 3

**SCHEDULE 1 - GENERAL CONDITIONS**

Item	Description	Drawing Reference	Unit of Measure	Estimated Quantity	Unit Price	Estimated Price = (Unit Price x Est. Quantity)
1.1	Contractor Use of Site + Mobilization / Demobilization	n/a	LS	1.00		
1.2	Work + Building Permit Application including fencing drawings,	n/a	LS	1.00		
1.3	One-year maintenance and warrenty	n/a	ea	1.00		
					<b>Sub-Total Schedule 1</b>	

Carry Forward the Sub-Total of Schedule 1 for calculation of Total Proposal Price

**SCHEDULE 2 - SELECTIVE DEMOLITION AND RELOCATION**

Item	Description	Drawing Reference	Unit of Measure	Estimated Quantity	Unit Price	Estimated Price = (Unit Price x Est.
2.1	Remove existing surface and/or excavate to 600mm ± depth	2-01	m2	117.90		
2.2	Remove existing concrete curb - Planter	2-02	l.m	26.70		
2.3	Remove existing road curb and gutter - Road	2-03	l.m	35.80		
2.4	Remove existing concrete paving and/or excavate to 480mm ± depth for heavy duty concrete paving.	2-05	m2	26.00		
2.5	Remove existing asphalt paving to 380mm ± depth required for pedestrian pavers.	2-06	m2	278.90		
2.6	Remove existing planting and planting soil to 450mm ± depth for pedestrian pavers.	2-09	m2	18.40		
2.7	Remove existing shrub	2-11	ea.	12.00		
2.8	Remove existing asphalt paving to 300mm ± depth required for concrete planter edge.	2-15	m2	11.40		
2.9	Coordination of utility work with external utility providers (ATCO + APEX)	8-05	LS	1.00		
2.10	Relocation of existing grease, recycle and garbage bins from existing location to new location within new waste enclosure	LM-101	LS	1.00		
					<b>Sub-Total Schedule 2</b>	

Carry Forward the Sub-Total of Schedule 2 for calculation of Total Proposal Price

**SCHEDULE 3 - SOFTSCAPE**

Item	Description	Drawing Reference	Unit of Measure	Estimated Quantity	Unit Price	Estimated Price = (Unit Price x Est. Quantity)
3.1	Planting Soil Type 1 - 975mm depth - 75mm Bark Mulch - 900mm Topsoil - Soil Amendments @ Rootball	3-01	cu.m.	69.63		
3.2	Planting Soil Type 2 - 375mm Depth - 75mm Bark Mulch - 300mm Topsoil @ Rootball - Soil Amendments	3-02	m2	15.90		
3.3	Bark Mulch Top-up in existing planter - 75mm Bark Mulch	3-03	m2	87.50		
<b>Sub-Total Schedule 3</b>						

Carry Forward the Sub-Total of Schedule 3 for calculation of Total Proposal Price

Project Title: DRUMHELLER DOWNTOWN PLAZA  
 Schedule B - SCHEDULE OF QUANTITIES  
 RFP 2022-02-15 - Addendum 3

**SCHEDULE 4 - HARDSCAPE**

Item	Description	Drawing Reference	Unit of Measure	Estimated Quantity	Unit Price	Estimated Price = (Unit Price x Est. Quantity)
4.1	Pedestrian Unit Paving: Procurement, and installation of unit pavers, sand setting bed, granular base and base. 4 unique colours to follow pattern	4-01	m2	287.20		
4.2	Concrete Paving - light duty	4-02	m2	12.50		
4.3	Concrete Paving - heavy duty	4-03	m2	32.70		
4.4	Asphalt paving repair	4-04	m2	110.50		
4.5	Standard curb and gutter - refer to Civil for details	4-05	l.m	34.20		
4.6	Concrete planter curb	4-06	l.m	61.20		
4.8	Flush concrete header	4-09	l.m	22.20		
<b>Sub-Total Schedule 4</b>						

Carry Forward the Sub-Total of Schedule 4 for calculation of Total Proposal Price

Project Title: DRUMHELLER DOWNTOWN PLAZA  
 Schedule B - SCHEDULE OF QUANTITIES  
 RFP 2022-02-15 - Addendum 3

**SCHEDULE 5 - FENCE AND GATES**

Item	Description	Drawing Reference	Unit of Measure	Estimated Quantity	Unit Price	Estimated Price = (Unit Price x Est. Quantity)
5.1	Waste bin enclosure	5-02	ea	1.00		
<b>Sub-Total Schedule 5</b>						

Carry Forward the Sub-Total of Schedule 5 for calculation of Total Proposal Price

**SCHEDULE 6 - SITE FURNISHING AND SITE FEATURES**

Item	Description	Drawing Reference	Unit of Measure	Estimated Quantity	Unit Price	Estimated Price = (Unit Price x Est. Quantity)
6.1	Waste receptacle (to be transported to site by Town and installed by Contractor on concrete pad)	6-08	ea	1.00		
6.2	Parking lot line paint	6-12	l.m	224.80		
6.3	Dinosaur themed benches	6-15	ea	8.00		
<b>Sub-Total Schedule 6A</b>						

Carry Forward the Sub-Total of Schedule 6 for calculation of Total Proposal Price



Project Title: DRUMHELLER DOWNTOWN PLAZA  
 Schedule B - SCHEDULE OF QUANTITIES  
 RFP 2022-02-15 - Addendum 3

**SCHEDULE 7 - STAGE**

Item	Description	Drawing Reference	Unit of Measure	Estimated Quantity	Unit Price	Estimated Price = (Unit Price x Est. Quantity)
7.1	Dino Stage Base - Cast-in-Place Concrete Platform with (2) 150mm high steps.	6-16	LS	1.00		
7.2	Dino Stage Canopy - Design Build of canopy, posts and footing of overhead structure. Includes the coordination and integration of proposed utilities - refer to Electrical Package as well as structural design and phasing of Stage within overall construction schedule	6-17	allowance	1.00	\$ 200,000.00	
<b>Sub-Total Schedule 7</b>						

Schedule "7" is subject to removal dependant on budget allowance. Will be determined following contract award.

Carry Forward the Sub-Total of Schedule 7 for calculation of Total Proposal Price

**SCHEDULE 8 - PLANTING**

Item	Description	Drawing Reference	Unit of Measure	Estimated Quantity	Unit Price	Estimated Price = (Unit Price x Est. Quantity)
8.1	Deciduous Tree 80mm Cal. - Malus baccata 'Rosthern' / Rosthern Crabapple	MR	ea	16.00		
8.2	Arenaria x 'Wallowa Mountains'/Wallowa Mountains Sandwort	AX	ea	182.00		
8.3	Aruncus aethusifolius / Dwarf Goatsbeard	AA2	ea	66.00		
8.4	Astilbe x 'Cappuccino' / Cappuccino Astilbe	AC	ea	118.00		
8.5	Echium amoenum/ Red Feathers	ER	ea	176.00		
8.6	Geum triflorum/Prairie Smoke	GT	ea	200.00		
8.7	Hemerocallis x 'Night Embers' / Night Embers Daylily	HN	ea	77.00		
8.8	Lupinus x 'Noble Maiden' / Noble Maiden white lupine	LX	ea	57.00		
<b>Sub-Total Schedule 8</b>						

Carry Forward the Sub-Total of Schedule 8 for calculation of Total Proposal Price

Project Title: DRUMHELLER DOWNTOWN PLAZA  
 Schedule B - SCHEDULE OF QUANTITIES  
 RFP 2022-02-15 - Addendum 3

**SCHEDULE 9 - ELECTRICAL**

Item	Description	Drawing Reference	Unit of Measure	Estimated Quantity	Unit Price	Estimated Price = (Unit Price x Est. Quantity)
9.1	Electrical - All electrical luminaires, cable, conduit, and equipment as outlined in Electrical	E2.4	ls	1.00		
<b>Sub-Total Schedule 9</b>						

Carry Forward the Sub-Total of Schedule 9 for calculation of Total Proposal Price

SCHEDULE 10 - IRRIGATION						(Unit Price x Est. Quantity)
Item	Description	Drawing Reference	Unit of Measure	Estimated Quantity	Unit Price	
10.1	Point of Connection: 38mm Watts 007 DCVA, Drain, 25mm Neptune Mach 10 Water Meter (Obtain from Town), Isolation Valve, and Blow Out	IR-01+IR-02	l.s.	1.00		
10.2	Controller Components and Control Wiring Assembly Parts: Hunter A2C-1200-P Irrigation Controller	IR-01+IR-02	ea	1.00		
10.3	Controller Components and Control Wiring Assembly Parts: Hunter Wireless Rain/Freeze-Click Sensor	IR-01+IR-02	ea	1.00		
10.4	Controller Components and Control Wiring Assembly Parts: 14 gauge control wire, 12 gauge common	IR-01+IR-02	l.s.	1.00		
10.5	Controller Components and Control Wiring Assembly Parts: 38mm Electrical Conduit	IR-01+IR-02	lm	10.00		
10.6	Sleeving: 100mm SDR 35 PVC Sleeve	IR-01+IR-02	lm	20.00		
10.7	Mainline: 38mm SDR 17.0 HDPE Mainline	IR-01+IR-02	lm	20.00		
10.8	Lateral: 25mm Prime 100 LDPE Lateral	IR-01+IR-02	lm	35.00		
10.9	Lateral: 38mm CSA Series 160 PVC SW Lateral	IR-01+IR-02	lm	90.00		
10.10	Electric Control Valve Assembly c/w Union, Ball Valve, AC Latching Solenoid and Valve Box: 25mm Hunter ICV-101G Electric Control Valve	IR-01+IR-02	ea	1.00		
10.11	Electric Control Valve Assembly c/w Union, Ball Valve, AC Latching Solenoid and Valve Box: 38mm Hunter ICV-151G Electric Control Valve	IR-01+IR-02	ea	1.00		
10.12	Irrigation Sprinklers c/w Swing Assembly, Check Valve: Hunter PROS-12-PRS30-CV Spray Sprinkler c/w Pro-Spray Fixed Nozzle	IR-01+IR-02	ea	40.00		
10.13	Miscellaneous Valves: 25mm Quick Coupler Valve /w Valve Box	IR-01+IR-02	ea	1.00		
10.14	One-year maintenance and warranty	n/a	ea	1.00		
<b>Sub-Total Schedule 10</b>						

Carry Forward the Sub-Total of Schedule 10 for calculation of Total Proposal Price

<b>SCHEDULE 11 - SITE SERVICING</b>						(Unit Price x Est. Quantity)
Item	Description	Drawing Reference	Unit of Measure	Estimated Quantity	Unit Price	
10.1	Water - 50mm pex		l.m	9.00		
10.2	Water - Curb Stop		ea.	1.00		
10.3	Water - Stop and Drain Valve		ea.	1.00		
10.4	Water - Tee 300mm x 300mm x 50mm		ea.	1.00		
10.5	Storm - 300mm PVC Pipe		l.m	4.00		
10.6	Storm - Type 5A Manhole		ea.	1.00		
10.7	Storm - CF k2 Assembly		ea.	1.00		
<b>Sub-Total Schedule 11</b>						

Carry Forward the Sub-Total of Schedule 11 for calculation of Total Proposal Price

**Part 1            General**

**1.1                SECTION INCLUDES**

- .1      Site enclosure.
- .2      Guardrails and barriers.
- .3      Weather enclosures.
- .4      Dust tight barriers.
- .5      Protection for off-site and public property.
- .6      Protection of applied finishes.
- .7      Protection of surrounding Work.

**1.2                RELATED SECTIONS**

- .1      This section describes requirements applicable to all Sections within Divisions 02 to 49.

**1.3                INSTALLATION AND REMOVAL**

- .1      Provide temporary controls in order to execute Work expeditiously.
- .2      Remove from site all such work after use.

**1.4                SITE ENCLOSURE**

- .1      Provide one (1) lockable truck entrance gate and at least one (1) pedestrian door as directed and conforming to applicable traffic restrictions on adjacent streets. Equip gates with locks and keys with restricted availability, in the project office.
- .2      Maintain pedestrian walkways routes complete with signs and electrical lighting as required by law.
- .3      Erect temporary site enclosure using new 1.2 m snow fence wired to rolled steel "T" bar fence, posts spaced at 2.4 m on centre.
  - .1      Provide [one (1)] lockable truck gate.
  - .2      Maintain site protection fencing in good repair.

**1.5                GUARD RAILS AND BARRIERS**

- .1      Provide secure, rigid guard rails and barricades around excavations and open edges of site demolition areas.

**1.6                WEATHER ENCLOSURES**

- .1      Design enclosures to withstand wind pressure and snow loading.

**1.7                DUST TIGHT BARRIERS**

- .1      Provide dust tight barriers and screens or insulated partitions to localize dust generating activities, and for protection of workers, finished areas of Work and public.

- .2 Maintain and relocate protection until such work is complete.

**1.8 PROTECTION FOR OFF-SITE AND PUBLIC PROPERTY**

- .1 Protect surrounding private and public property from damage during performance of Work.
- .2 Be responsible for damage incurred.

**1.9 PROTECTION OF APPLIED FINISHES**

- .1 Provide protection for finished and partially finished surfaces and equipment during performance of Work.
- .2 Provide necessary screens, covers, and hoardings.
- .3 Confirm with Consultant locations and installation schedule three (3) days prior to installation.
- .4 Be responsible for damage incurred due to lack of or improper protection.

**1.10 PROTECTION OF SURROUNDING WORK**

- .1 Provide protection for finished and partially finished Work from damage.
- .2 Provide necessary cover and protection.
- .3 Be responsible for damage incurred due to lack of or improper or inappropriate protection.

**END OF SECTION**

SHEET INDEX - NAME AND NUMBERING CONVENTION

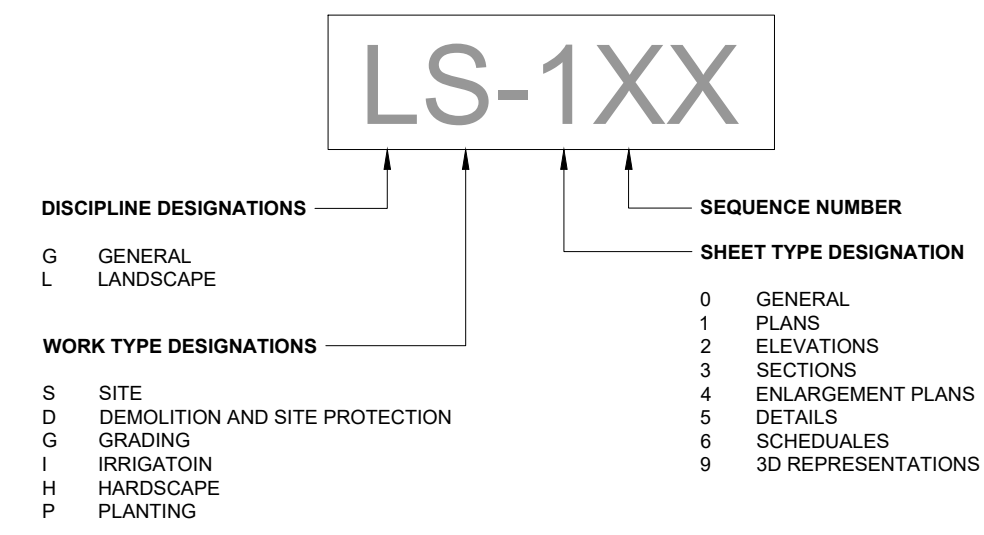

DEMOLITION LEGEND

SYMBOL	1 GENERAL CONDITIONS DESCRIPTION	QTY
	1-01 CONSTRUCTION LAYDOWN AREA.	255.4 m²
SYMBOL	2 SELECTIVE DEMOLITION & RELOCATIONS DESCRIPTION	QTY
	2-01 REMOVE EXISTING SURFACE AND/OR EXCAVATE TO 600MM ± DEPTH	117.9 m²
	2-02 REMOVE EXISTING CONCRETE CURB - PLANTER	26.7 m
	2-03 REMOVE EXISTING CONCRETE CURB AND GUTTER - ROAD	35.8 m
	2-05 REMOVE EXISTING CONCRETE PAVING TO 480MM ± DEPTH FOR HEAVY DUTY CONCRETE PAVING	26.0 m²
	2-06 REMOVE EXISTING ASPHALT PAVING TO 380MM ± DEPTH REQUIRED FOR PEDESTRIAN PAVERS. REFER TO LM-100.	278.9 m²
	2-09 REMOVE EXISTING PLANTING AND PLANTING SOIL TO 450MM± DEPTH FOR PEDESTRIAN PAVERS. REFER TO LM-100	18.4 m²
	2-11 EXISTING SHRUB TO BE REMOVED	12
	2-15 REMOVE EXISTING ASPHALT PAVING TO 300MM ± DEPTH REQUIRED FOR CONCRETE PLANTER EDGE. REFER TO LM-100.	11.4 m²
SYMBOL	8 ELECTRICAL DESCRIPTION	QTY
	8-05 EXISTING LAMP TO BE REMOVED BY ATCO. CONTRACTOR TO COORDINATE TIMING.	1

MATERIALS LEGEND

SYMBOL	3 SOFTSCAPE DESCRIPTION	QTY
	3-01 PLANTING SOIL TYPE 1 - 975MM DEPTH - 75MM BARK MULCH - 900MM TOPSOIL	69.63 m³
	3-02 PLANTING SOIL TYPE 2 - 375MM DEPTH 3/LP-502 - 75MM BARK MULCH - 300MM TOPSOIL @ ROOTBALL - SOIL AMENDMENTS (REFER TO SPECS)	
	3-03 BARK MULCH TOPUP IN EXISTING PLANTER - 75MM BARK MULCH	87.5 m³
SYMBOL	4 HARDSCAPE DESCRIPTION	QTY
	4-01 PEDESTRIAN UNIT PAVING - 65MM PAVERS - 25MM SAND SETTING BED	287.2 m²
	4-02 CONCRETE PAVING - LIGHT DUTY - CONTROL JOINTS EVERY 1.5M2 - EXPANSION JOINTS EVERY 3M2	12.5 m²
	4-03 CONCRETE PAVING - HEAVY DUTY - CONTROL JOINTS EVERY 1.5M2 - EXPANSION JOINTS EVERY 3M2	32.7 m²
	4-04 ASPHALT PAVING REPAIR - 75MM ASPHALT - 200 MM DEPTH 20MM DIAMETER CRUSH - 300MM DEPTH PITRUN	98.3 m²
	4-05 STANDARD CURB AND GUTTER	34.3 m
	4-06 CONCRETE PLANTER CURB - 200MM HEIGHT ABOVE GRADE - 200MM WIDTH	61.2 m
	4-09 FLUSH CONCRETE HEADER - 200MM WIDE	22.2 m
SYMBOL	5 FENCES & GATES DESCRIPTION	QTY
	5-02 WASTE BIN ENCLOSURE	13.1 m
SYMBOL	6 SITE FURNISHINGS & FEATURES DESCRIPTION	QTY
	6-01 TOWN OF DRUMHELLER EXISTING PLANTERS TO BE RELOCATED FROM EXISTING STAGE AREA BY CONTRACTOR.	8
	6-08 WASTE RECEPTACLE	1
	6-12 PARKING LOT LINE PAINT	225.8 m
	6-13 EXISTING BISTRO TABLE	5
	6-15 DINOSAUR THEMED BENCHES	8
	6-16 DINO STAGE - DESIGN BUILD. FOR INFORMATION ONLY C.I.P. PLATFORM - 150MM HIGH CONC STEPS - 150MM HIGH - 500MM WIDE	48.4 m
	6-17 DINO STAGE - DESIGN BUILD. FOR INFORMATION ONLY CANOPY	1
SYMBOL	8 ELECTRICAL DESCRIPTION	QTY
	8-01 PEDESTRIAN LIGHT	6
	8-02 PEDESTAL	3

PLANTING LEGEND

TREES	CODE	BOTANICAL / COMMON NAME	CONTAINER	CALIPER	QTY
	MR	MALUS BACCATA 'ROSTERN' / ROSTERN CRABAPPLE	B & B	75MM CAL	16
SHRUBS	CODE	BOTANICAL / COMMON NAME	CONTAINER	I	QTY
	AX	ARENARIA X 'WALLOWA MOUNTAINS' / WALLOWA MOUNTAINS SANDWORT	1 GAL	0.3M	182
	AA2	ARUNCUS AETHUSIFOLIUS / DWARF GOATSBEARD	2 GAL	0.3M	66
	AC	ASTILBE X 'CAPPUCCINO' / CAPPUCCINO ASTILBE	2 GAL	0.4M	118
	ER	ECHUM AMOENUM / RED FEATHERS	1 GAL	0.2M	176
	GT	GEUM TRIFLORUM / PRAIRIE SMOKE	1 GAL	0.2M	200
	HN	HEMEROCALLIS X 'NIGHT EMBERS' / NIGHT EMBERS DAYLILY	2 GAL	0.6M	77
	LX	LUPINUS X 'NOBLE MAIDEN' / NOBLE MAIDEN WHITE LUPINE	2 GAL	0.5M	57

PROJECT  
**DRUMHELLER  
 DOWNTOWN PLAZA**  
 FOR  
 MUNICIPALITY OF DRUMHELLER

CONSULTANTS



SEALS

KEYMAP



ISSUED FOR: LANDSCAPE ADDENDUM #3  
 DATE: 2022-03-09

REVISIONS:	NO.	DESCRIPTION.	DATE.	BY.
	3	ISSUED LANDSCAPE ADDENDUM #3	2022-03-09	
	2	ISSUED LANDSCAPE ADDENDUM #1	2022-02-18	
	1	ISSUED FOR TENDER	2022-02-15	

DESIGNED BY: ZW/MW CHECKED BY: MW

DRAWING TITLE :  
**SCHEDULES**

**G-001**



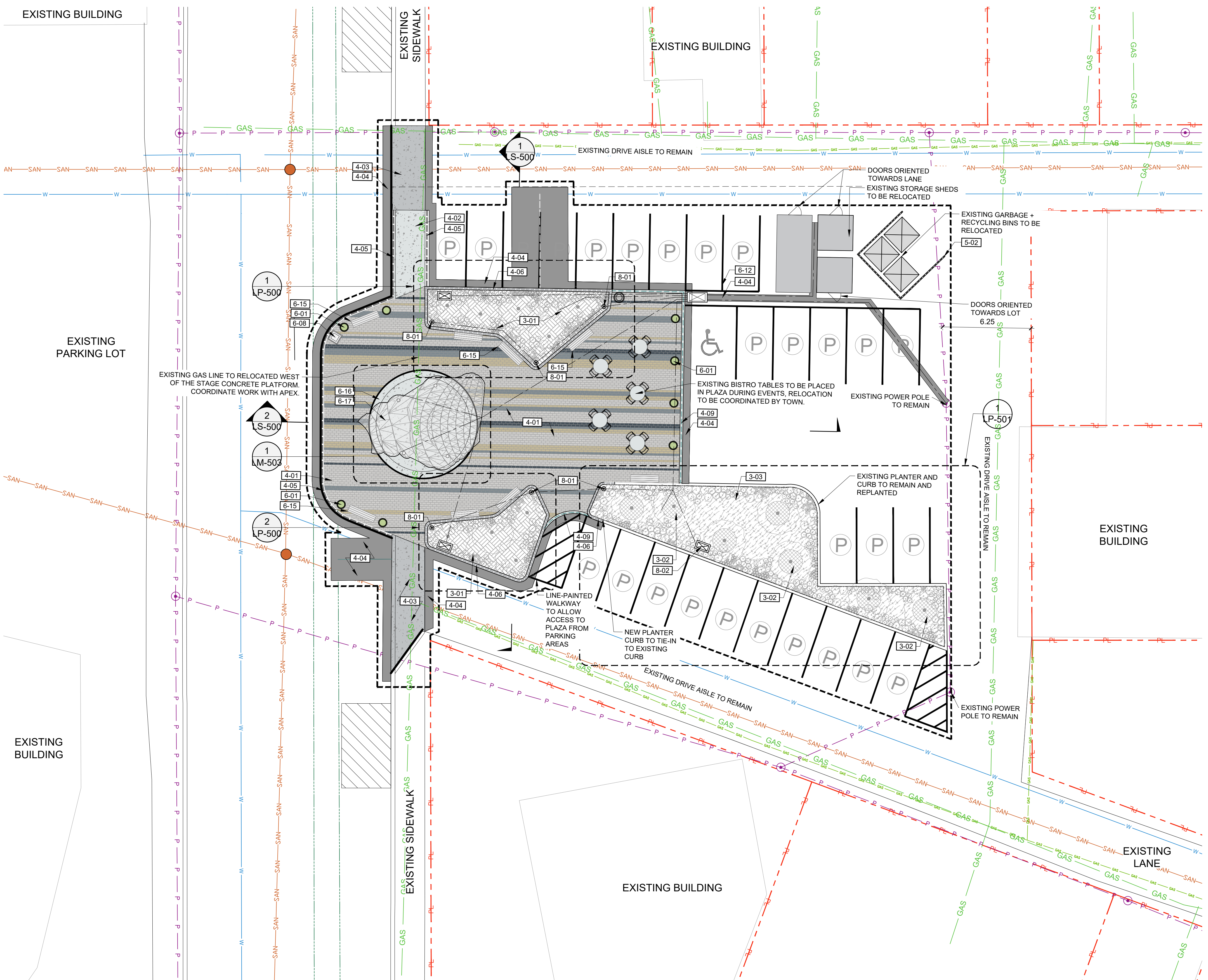

**MATERIALS LEGEND**

SYMBOL	3 SOFTSCAPE DESCRIPTION	QTY	DETAIL
[Symbol]	3-01 PLANTING SOIL TYPE 1 - 975MM DEPTH - 75MM BARK MULCH - 900MM TOPSOIL	69.63 m <sup>2</sup>	5/LP-502
[Symbol]	3-02 PLANTING SOIL TYPE 2 - 375MM DEPTH 3/LP-502 - 75MM BARK MULCH - 300MM TOPSOIL @ ROOTBALL - SOIL AMENDMENTS (REFER TO SPECS)	15.9 m <sup>2</sup>	
[Symbol]	3-03 BARK MULCH TOPUP IN EXISTING PLANTER - 75MM BARK MULCH	87.5 m <sup>2</sup>	5/LP-502
SYMBOL	4 HARDSCAPE DESCRIPTION	QTY	DETAIL
[Symbol]	4-01 PEDESTRIAN UNIT PAVING - 65MM PAVERS - 25MM SAND SETTING BED	287.2 m <sup>2</sup>	1/LM-500
[Symbol]	4-02 CONCRETE PAVING - LIGHT DUTY - CONTROL JOINTS EVERY 1.5M2 - EXPANSION JOINTS EVERY 3M2	12.5 m <sup>2</sup>	2/LM-500
[Symbol]	4-03 CONCRETE PAVING - HEAVY DUTY - CONTROL JOINTS EVERY 1.5M2 - EXPANSION JOINTS EVERY 3M2	32.7 m <sup>2</sup>	3/LM-500
[Symbol]	4-04 ASPHALT PAVING REPAIR - 75MM ASPHALT - 200 MM DEPTH 20MM DIAMETER CRUSH - 300MM DEPTH PITRUN	98.3 m <sup>2</sup>	5/LM-500
[Symbol]	4-05 STANDARD CURB AND GUTTER	34.3 m	REFER TO CIVIL
[Symbol]	4-06 CONCRETE PLANTER CURB - 200MM HEIGHT ABOVE GRADE - 200MM WIDTH	61.2 m	7/LM-500
[Symbol]	4-09 FLUSH CONCRETE HEADER - 200MM WIDE	22.2 m	9/LM-500
SYMBOL	5 FENCES & GATES DESCRIPTION	QTY	DETAIL
[Symbol]	5-02 WASTE BIN ENCLOSURE	13.1 m	6/LM-502
SYMBOL	6 SITE FURNISHINGS & FEATURES DESCRIPTION	QTY	DETAIL
[Symbol]	6-01 TOWN OF DRUMHELLER EXISTING PLANTERS TO BE RELOCATED FROM EXISTING STAGE AREA BY CONTRACTOR.	8	REFER TO SPECS
[Symbol]	6-08 WASTE RECEPTACLE	1	REFER TO SPECS
[Symbol]	6-12 PARKING LOT LINE PAINT	225.8 m	2/LM-501
[Symbol]	6-13 EXISTING BISTRO TABLE	5	REFER TO SPECS
[Symbol]	6-15 DINOSAUR THEMED BENCHES	8	REFER TO SPECS
[Symbol]	6-16 DINO STAGE - DESIGN BUILD, FOR INFORMATION ONLY C.I.P. PLATFORM - 150MM HIGH CONC STEPS - 150MM HIGH - 500MM WIDE	48.4 m	12/LM-500
[Symbol]	6-17 DINO STAGE - DESIGN BUILD, FOR INFORMATION ONLY CANOPY	1	LM-503
SYMBOL	8 ELECTRICAL DESCRIPTION	QTY	DETAIL
[Symbol]	8-01 PEDESTRIAN LIGHT	6	REFER TO ELECTRICAL
[Symbol]	8-02 PEDESTAL	3	REFER TO ELECTRICAL

**GENERAL LEGEND**

- LIMIT OF WORK
- - - - - PROPERTY LINE

**UTILITIES LEGEND**

- ⊙ EXISTING POWER POLE
- P — EXISTING OVERHEAD POWER LINE
- EXISTING CURB
- EXISTING STORM SEWER
- SAN — EXISTING SANITARY LINE
- W — EXISTING WATER LINE
- GAS — EXISTING GAS LINE
- GAS — EXISTING GAS LINE TO BE RELOCATED BY APEX
- PROPOSED UNDERGROUND POWER LINES
- ⊙ PROPOSED IRRIGATION SPRINKLERS
- PROPOSED IRRIGATION LINES

**TOTAL PARKING STALLS: 28**

**PROJECT**  
**DRUMHELLER**  
**DOWNTOWN PLAZA**  
**FOR**  
**MUNICIPALITY OF DRUMHELLER**

**CONSULTANTS**



**SEALS**



ISSUED FOR: LANDSCAPE ADDENDUM #3  
DATE: 2022-03-09

REVISIONS:	NO.	DESCRIPTION.	DATE.	BY.
	3	ISSUED LANDSCAPE ADDENDUM #3	2022-03-09	
	2	ISSUED LANDSCAPE ADDENDUM #1	2022-02-18	
	1	ISSUED FOR TENDER	2022-02-15	

DESIGNED BY: ZW/MW CHECKED BY: MW  
PLOT DATE: 2022-02-22  
DRAWING FILE NAME:  
LM-100 PHASE 1 MATERIALS PLAN.dwg

**DRAWING TITLE:**  
**PLAZA - PHASE 1**

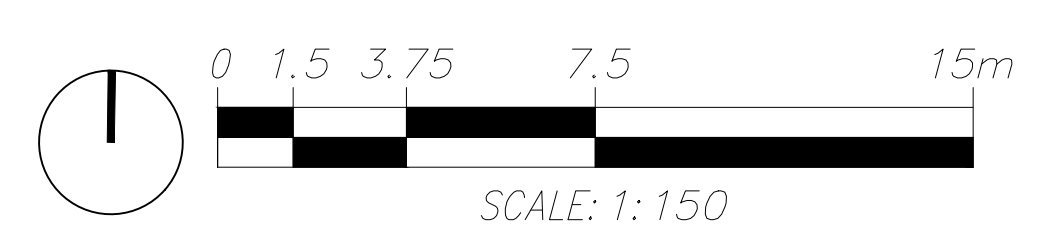

**LM-101**

CONSULTANTS



SEALS

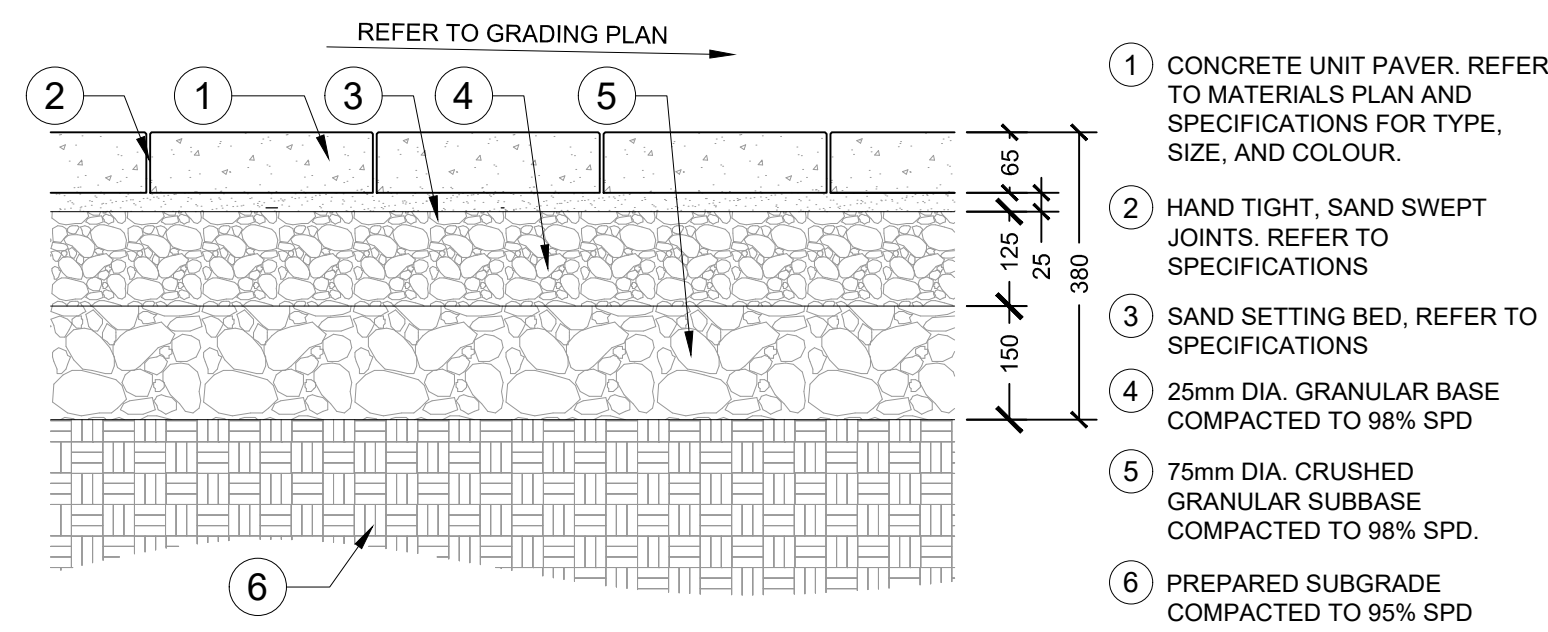

**1 PEDESTRIAN UNIT PAVING**  
 1:10 P-O2-DRU-74

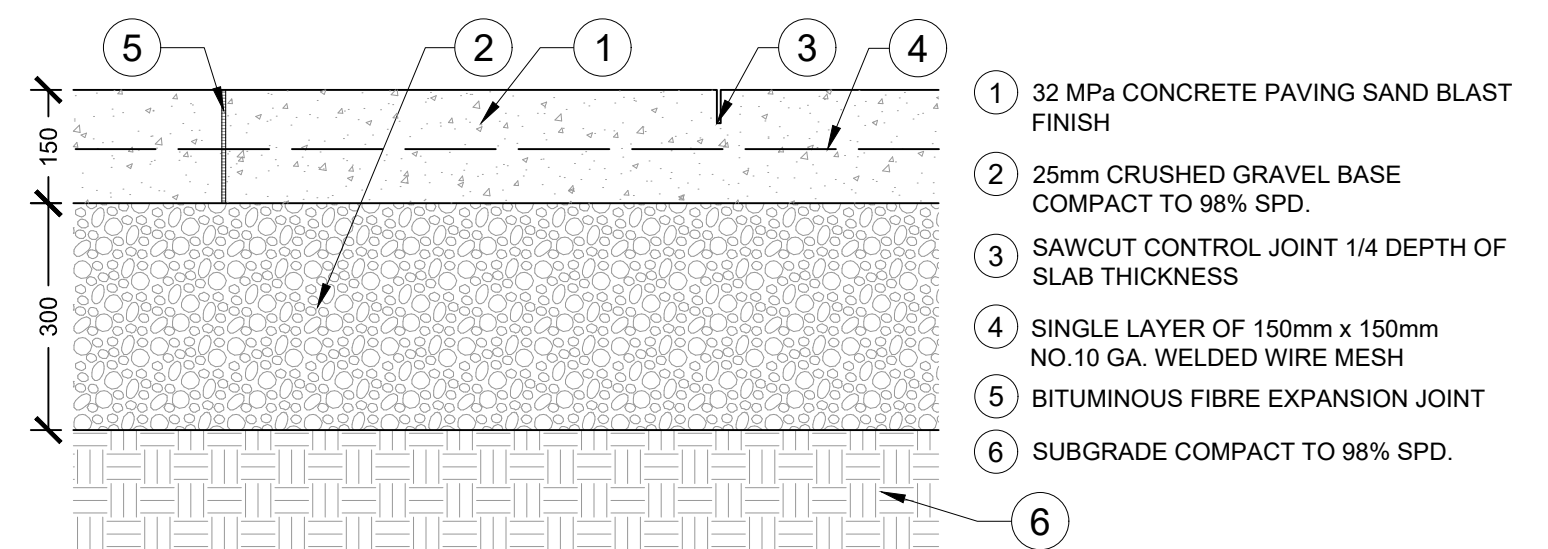

**2 CONCRETE PAVING - LIGHT DUTY**  
 1:10 P-O2-DRU-43

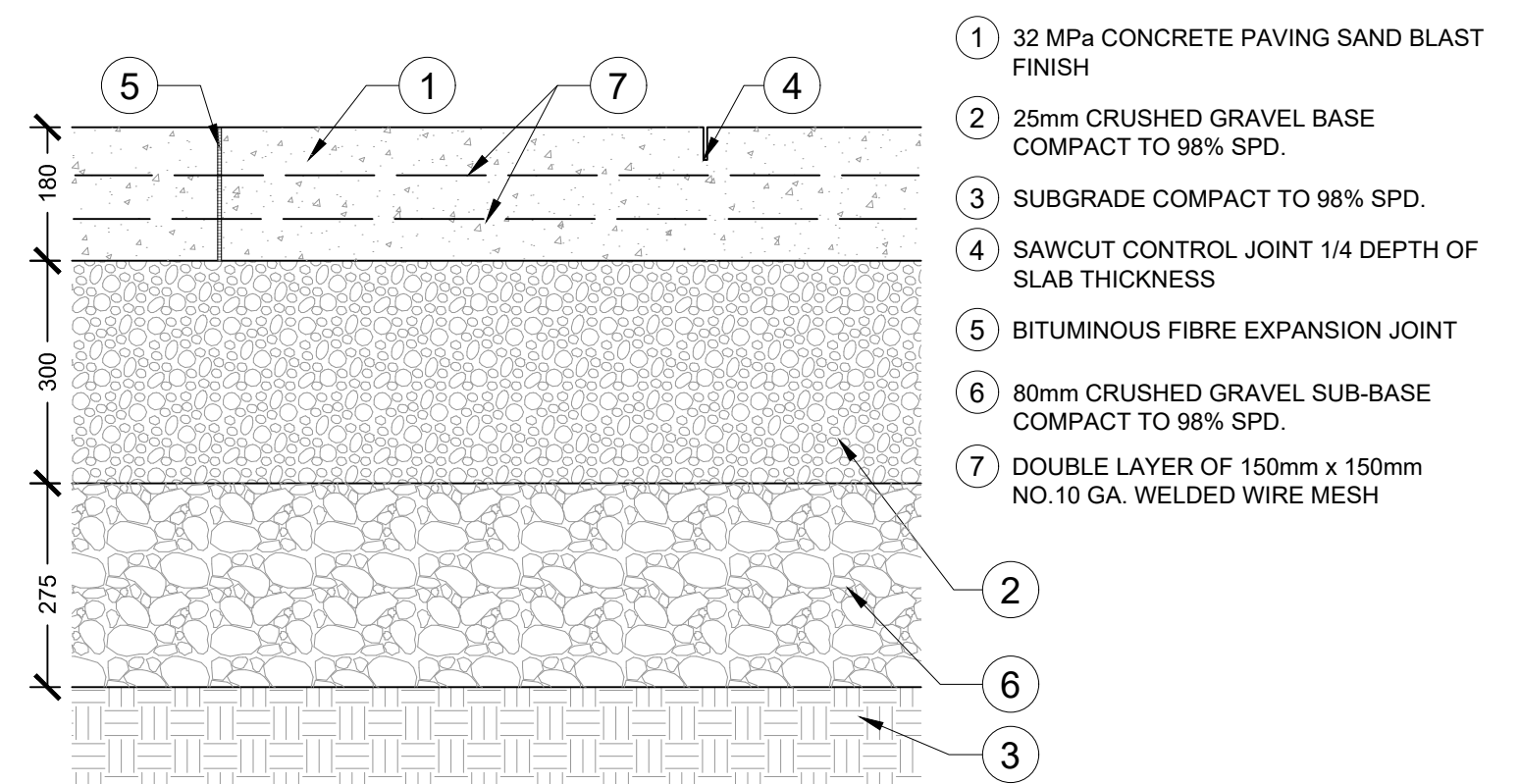

**3 CONCRETE PAVING - HEAVY DUTY**  
 1:10 P-O2-DRU-44

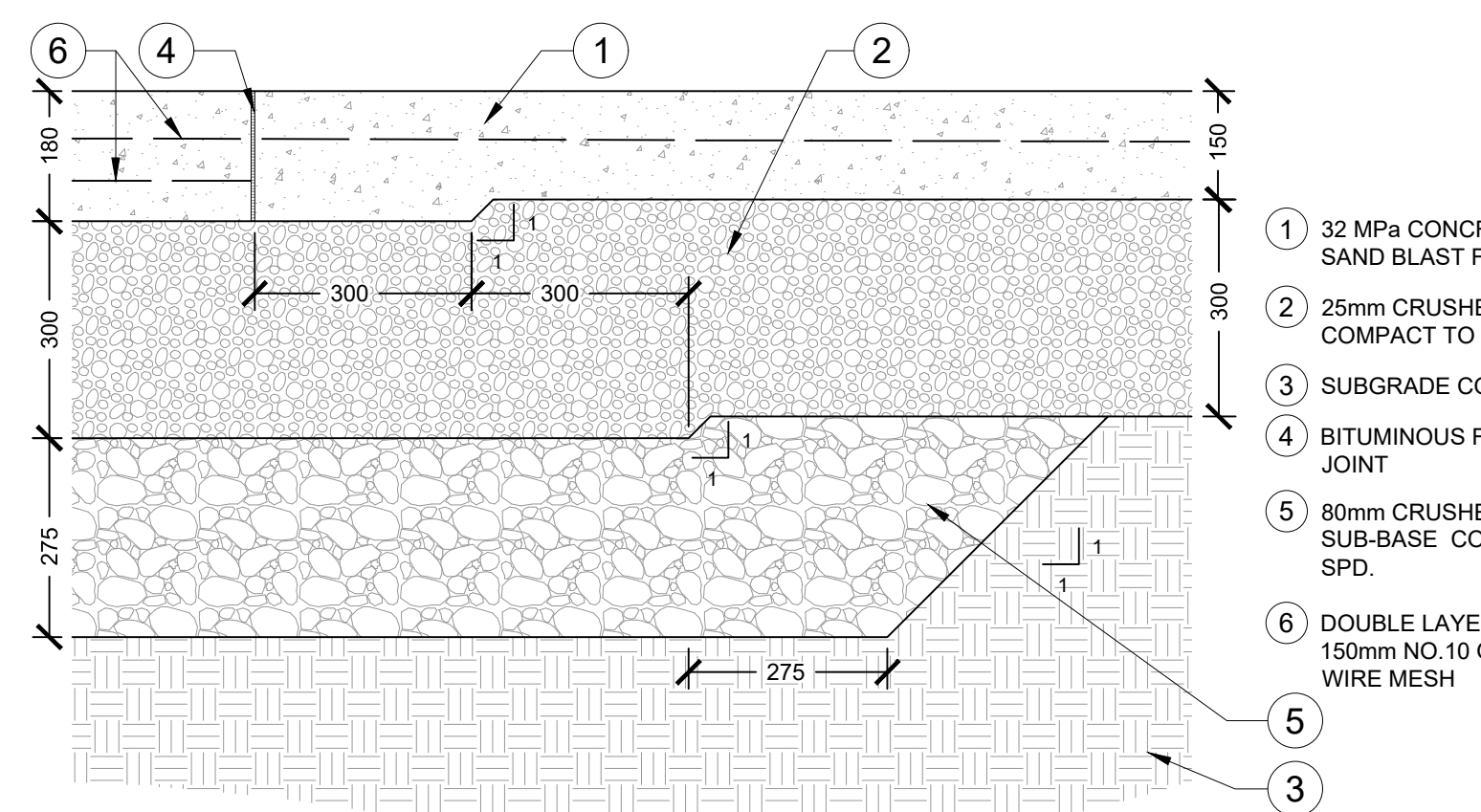

**4 TRANSITION - LIGHT DUTY TO HEAVY DUTY CONCRETE**  
 1:10 P-O2-DRU-45

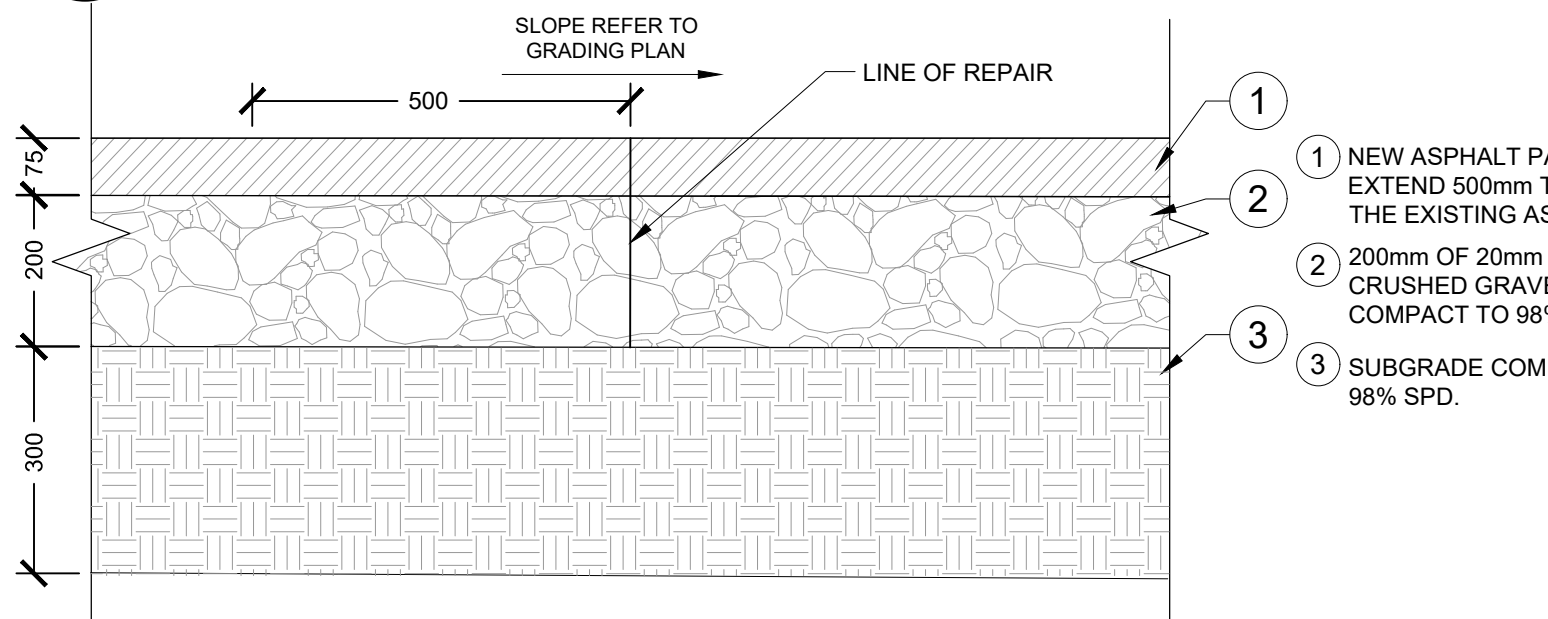

**5 ASPHALT - REPAIR**  
 1:10 P-O2-DRU-75

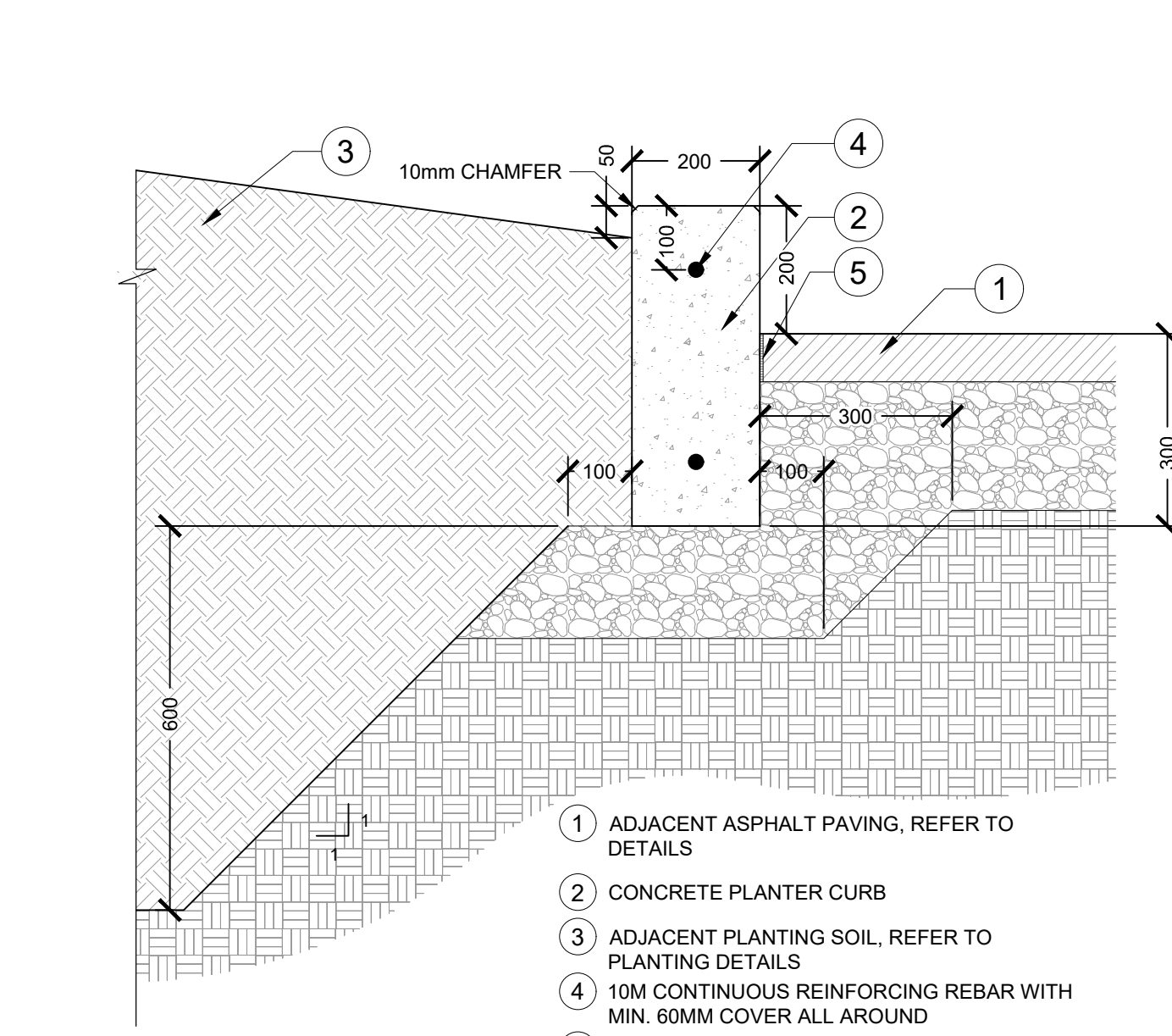

**8 CONCRETE PLANTER CURB ADJACENT TO ASPHALT - NEW POUR**  
 1:10 P-O2-DRU-78

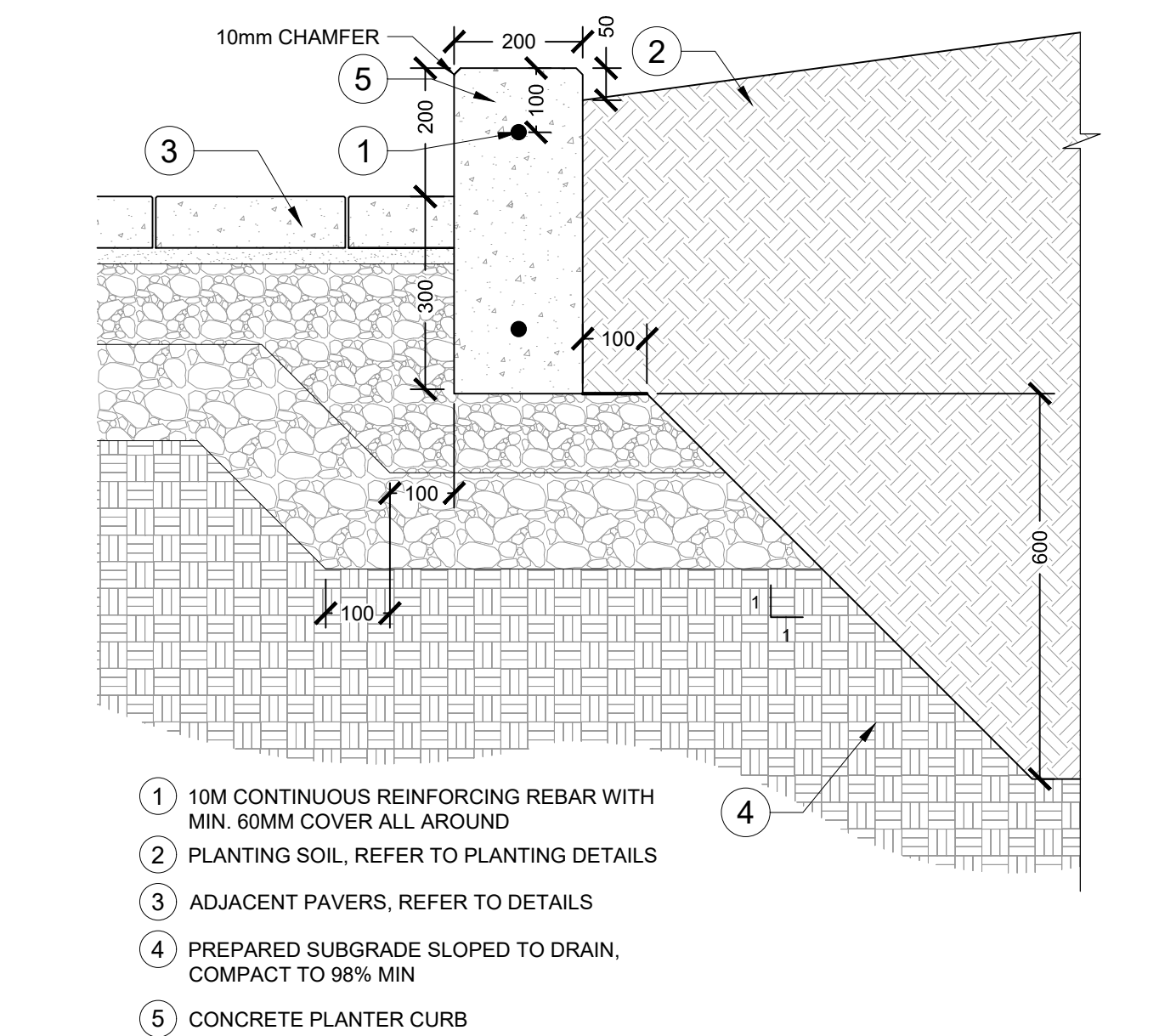

**7 CONCRETE PLANTER CURB ADJACENT TO PAVERS - NEW POUR**  
 1:10 P-O2-DRU-77

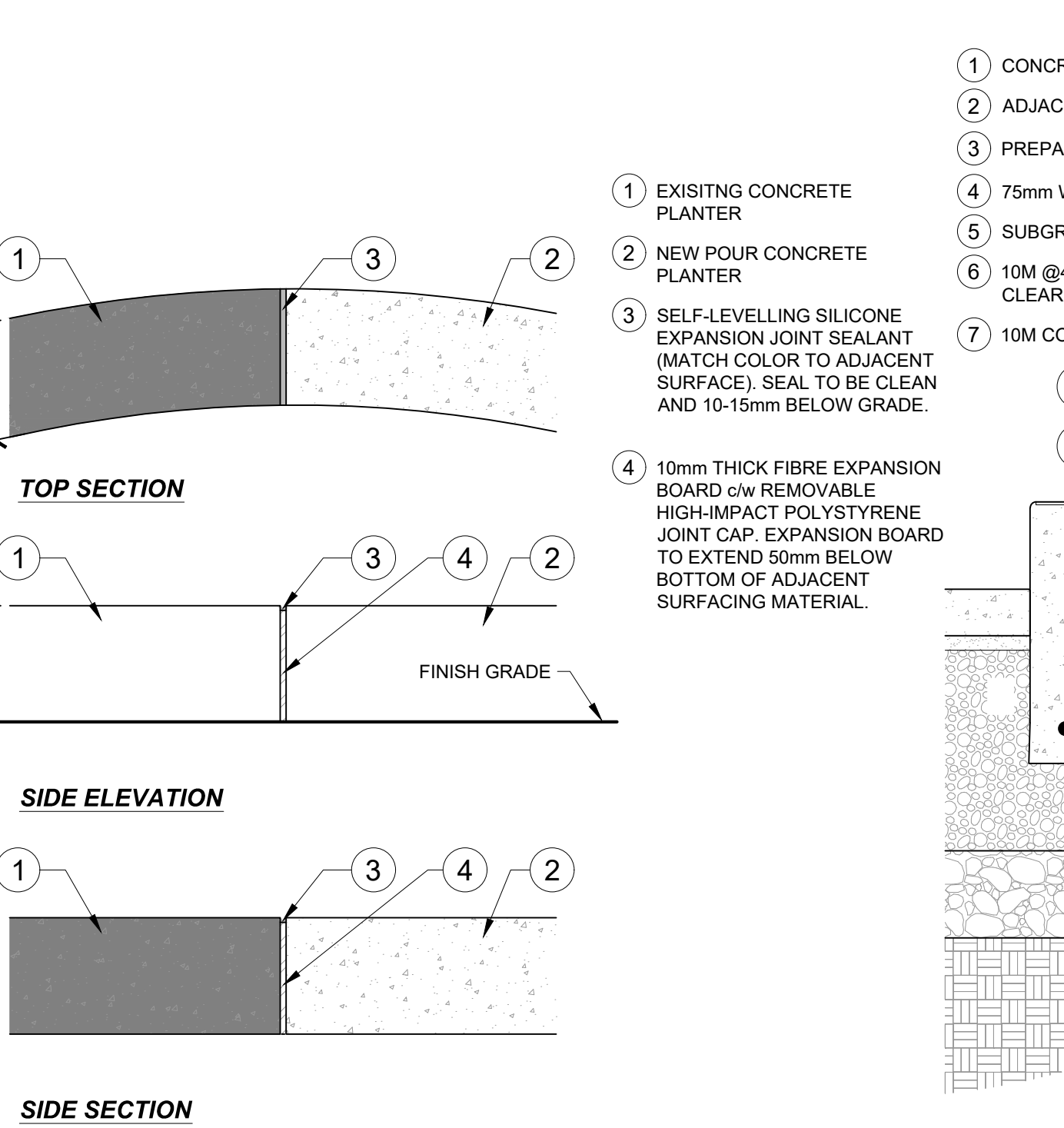

**6 CONCRETE PLANTER CURB - REPAIR / PATCH**  
 1:10 P-O2-DRU-76

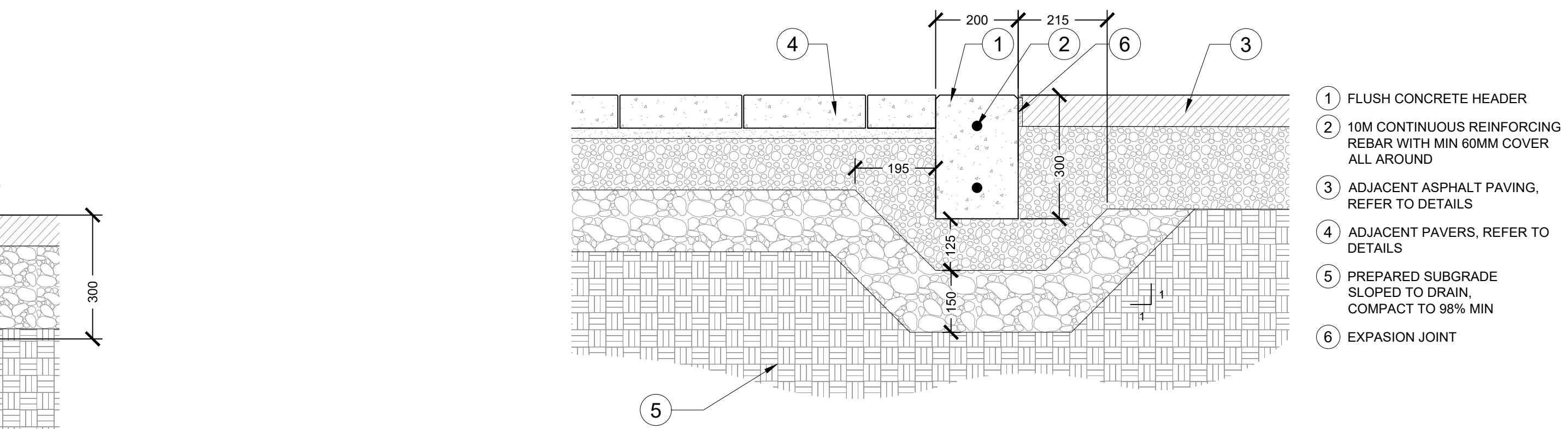

**9 FLUSH CONCRETE HEADER**  
 1:10 P-O2-DRU-79

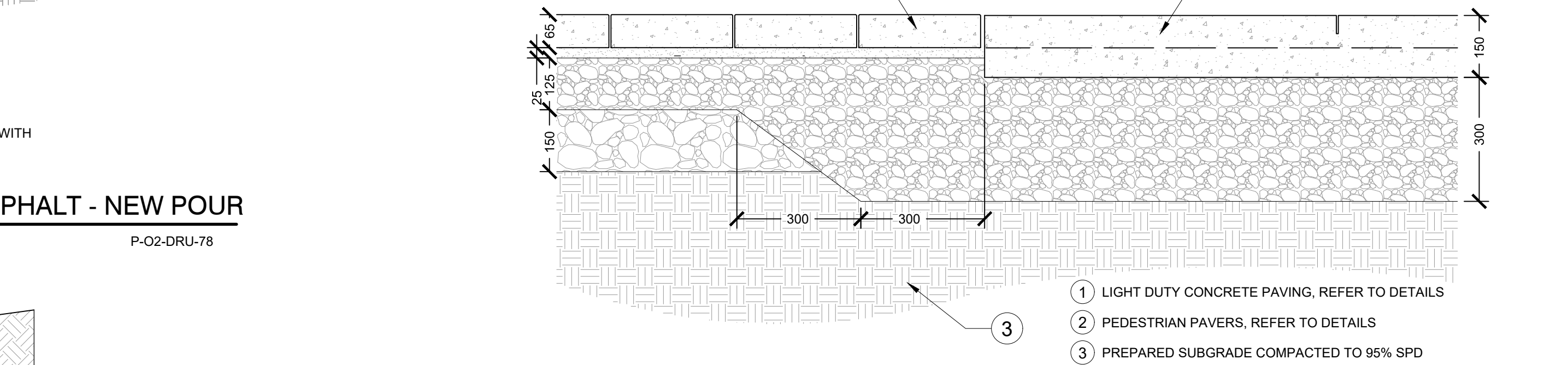

**10 PEDESTRIAN PAVERS AND LIGHT DUTY CONCRETE PAVING CONNECTION**  
 1:10 P-O2-DRU-91

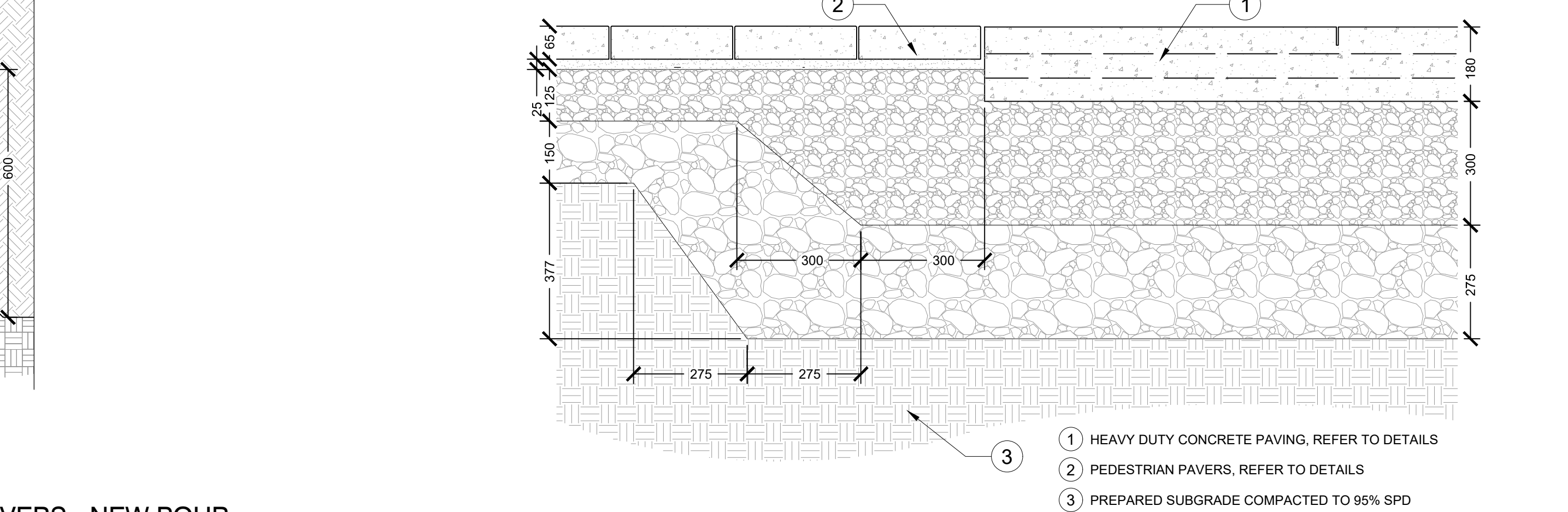

**11 PEDESTRIAN PAVERS AND HEAVY DUTY CONCRETE PAVING CONNECTION**  
 1:10 P-O2-DRU-92

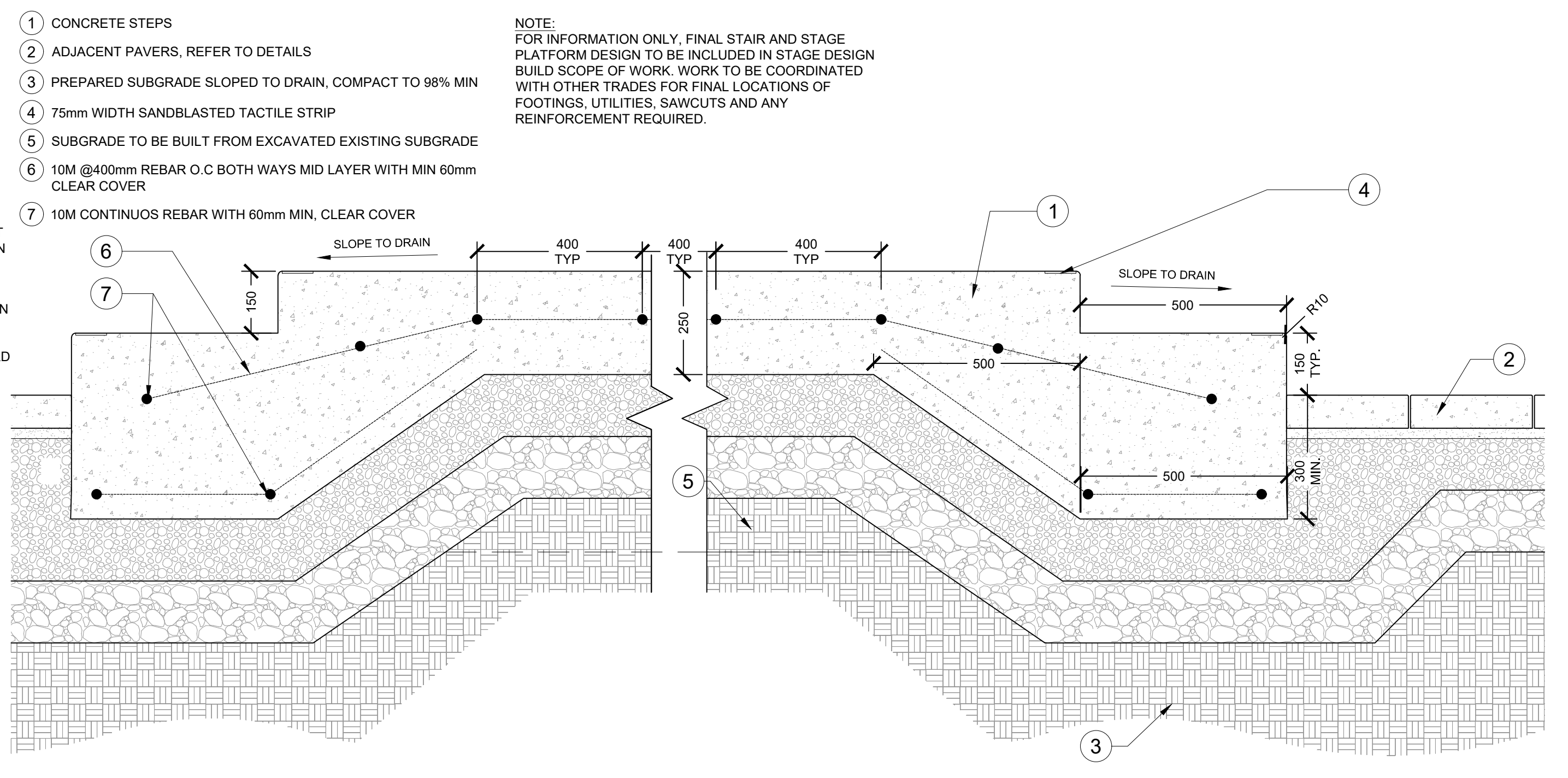

**12 CONCRETE STEPS AT STAGE - STAGE DESIGN BUILD / FOR INFORMATION ONLY**  
 1:10 P-O2-DRU-80



ISSUED FOR: LANDSCAPE ADDENDUM #1  
 DATE: 2022-02-18

NO.	DESCRIPTION	DATE	BY
2	ISSUED LANDSCAPE ADDENDUM #1	2022-02-18	
1	ISSUED FOR TENDER	2022-02-15	

DESIGNED BY: ZW/MW  
 CHECKED BY: MW  
 PLOT DATE: 2022-02-15  
 DRAWING FILE NAME: LM-500 PAVEMENT DETAILS.dwg

DRAWING TITLE:  
**PAVEMENT DETAILS**

**LM-500**

PROJECT  
**DRUMHELLER  
 DOWNTOWN PLAZA**  
 FOR  
 MUNICIPALITY OF DRUMHELLER

CONSULTANTS



SEALS

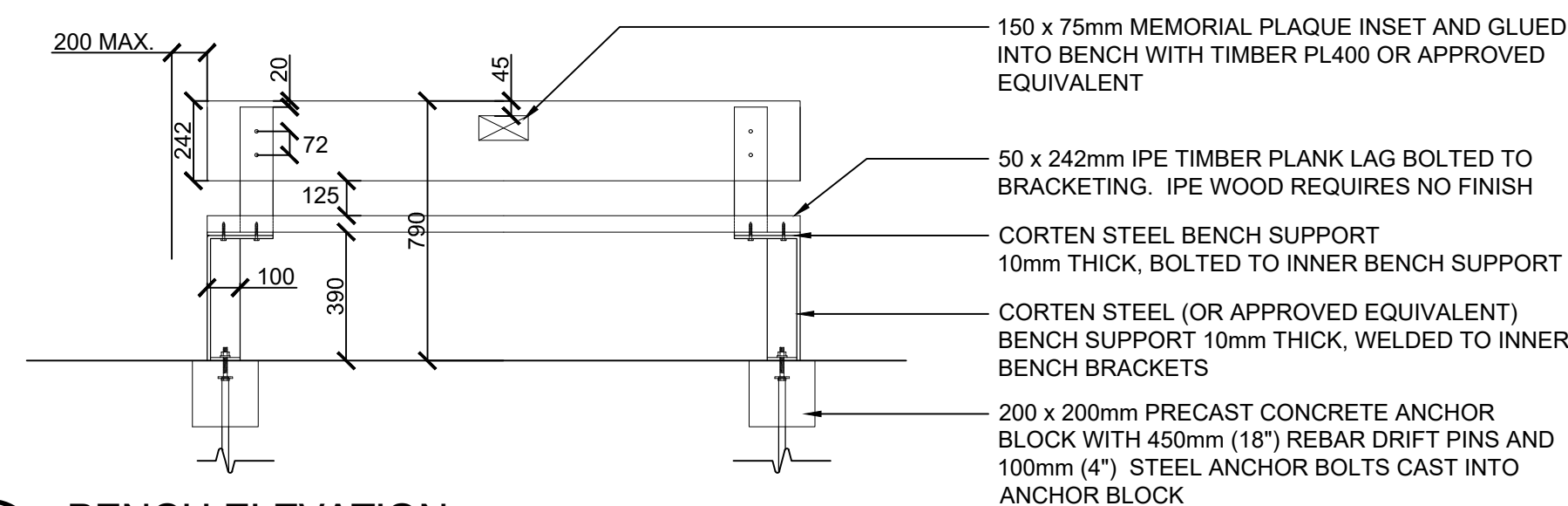
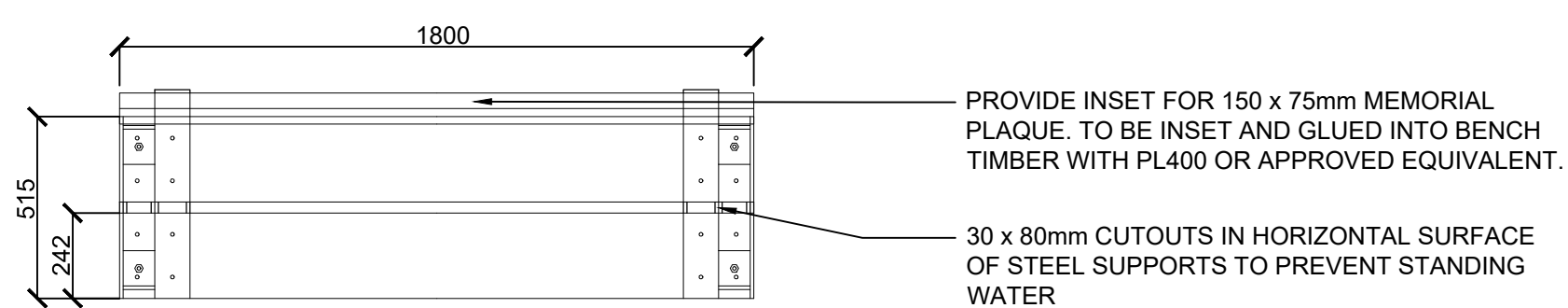
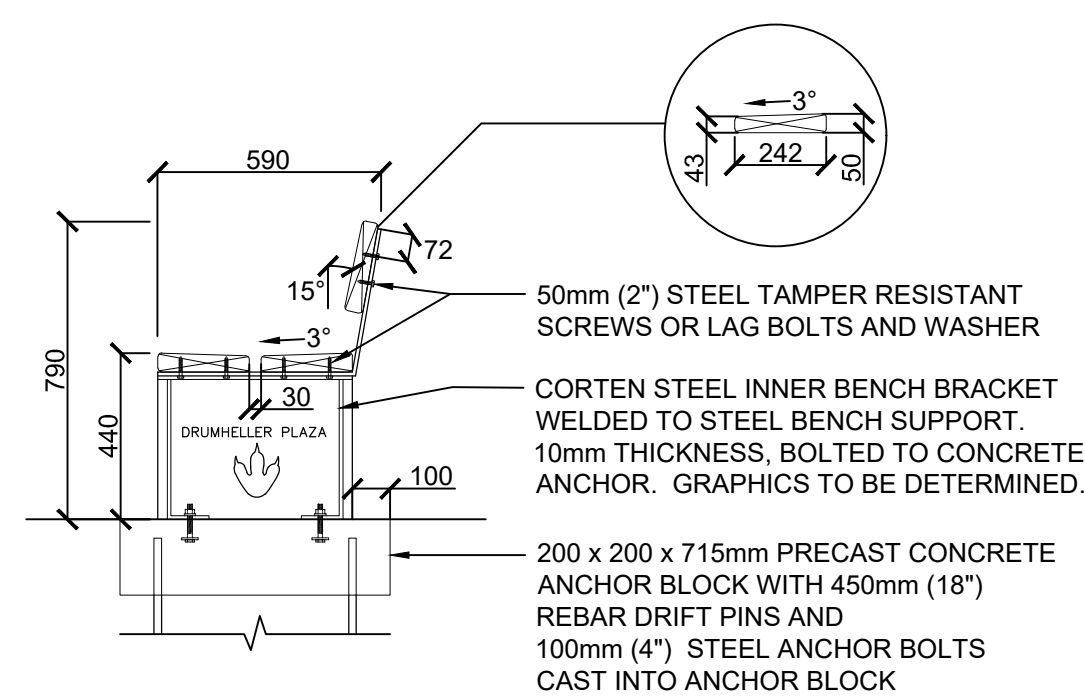

**1** DINOSAUR THEMED BENCH WITH BACKREST  
 1:20 P-O2-DRU-103

**2** BENCH PLAN  
 1:20 P-O2-DRU-104

**3** BENCH ELEVATION  
 1:20 P-O2-DRU-105

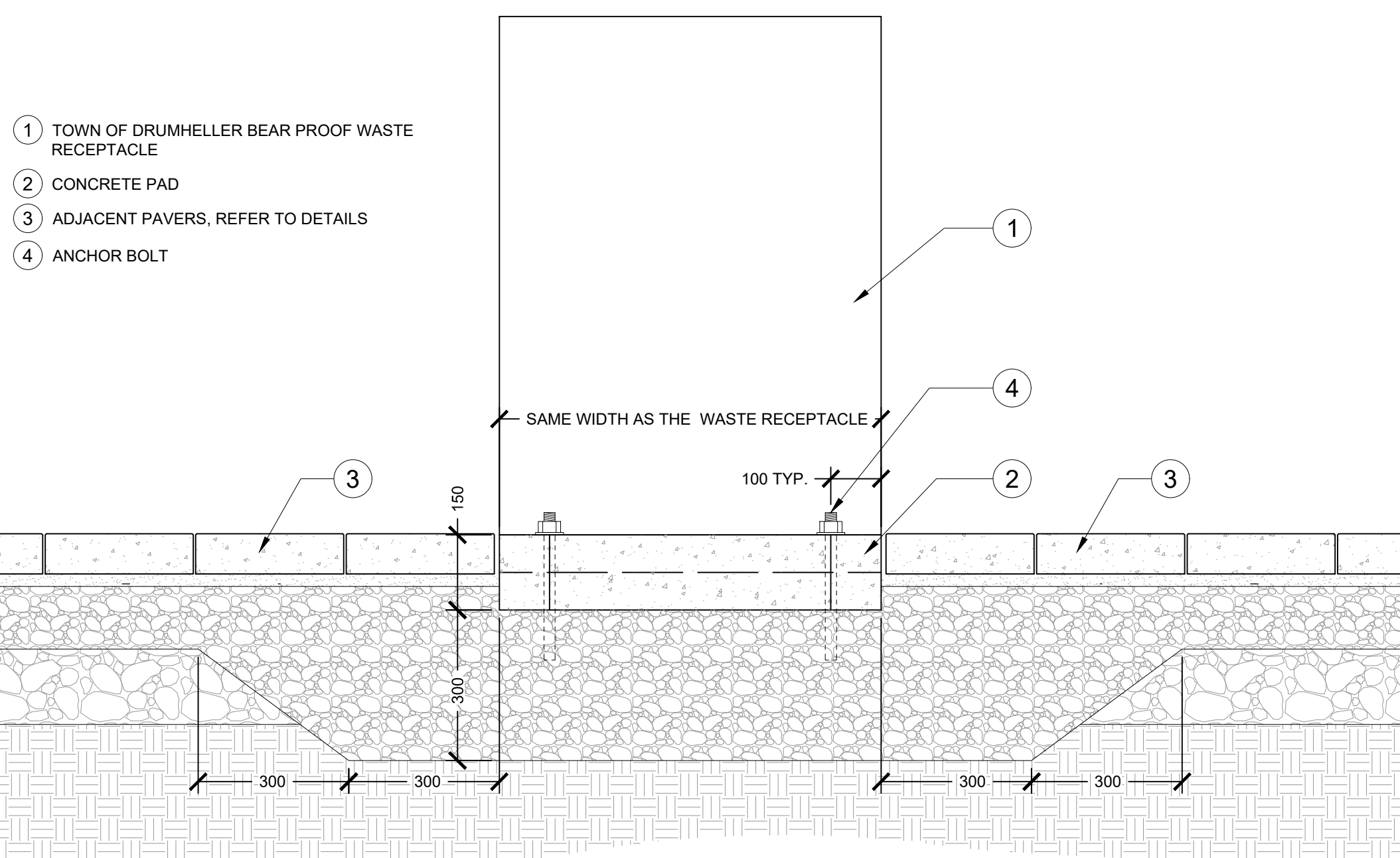

**4** WASTE RECEPTACLE  
 1:10 P-O2-DRU-93

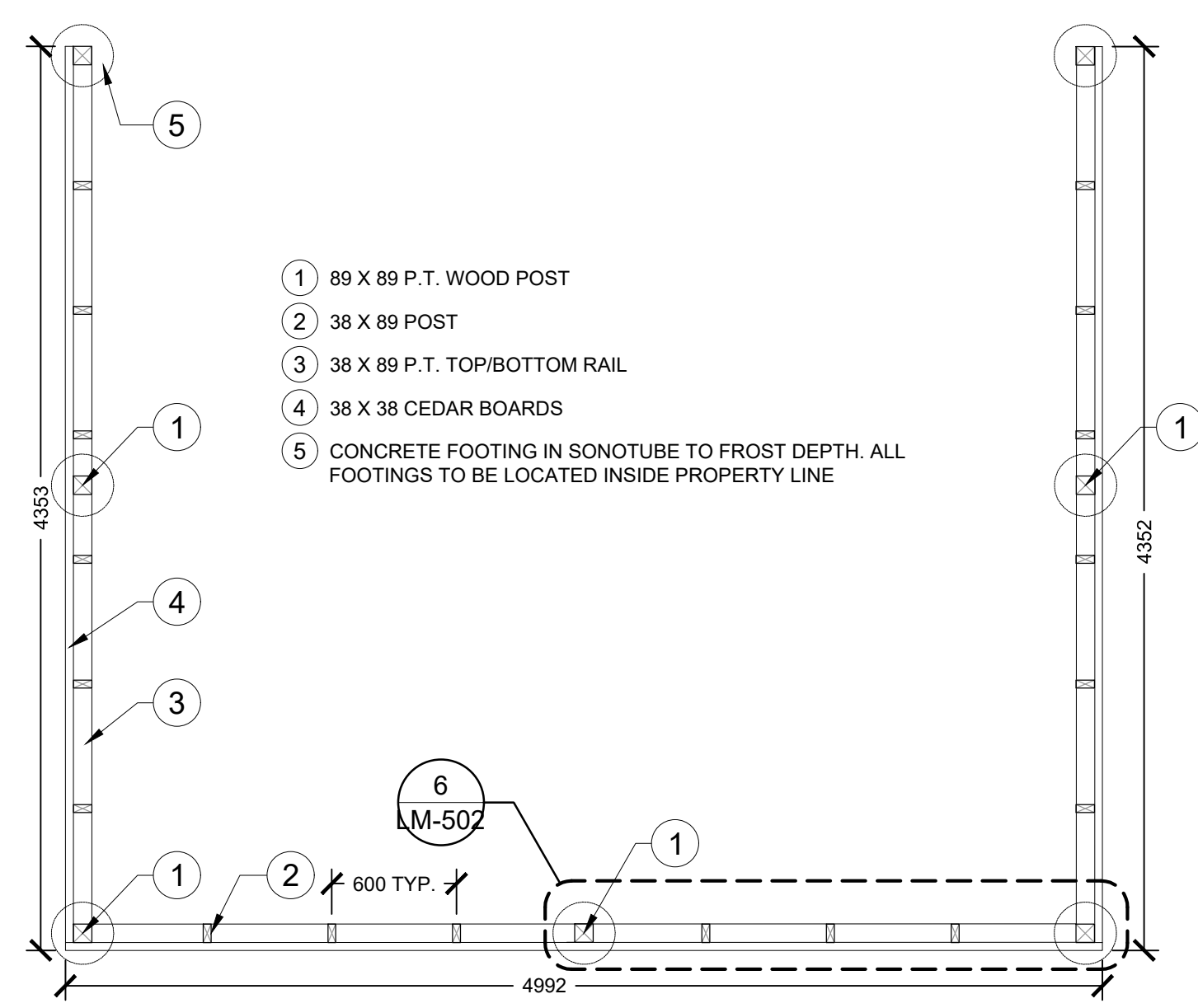
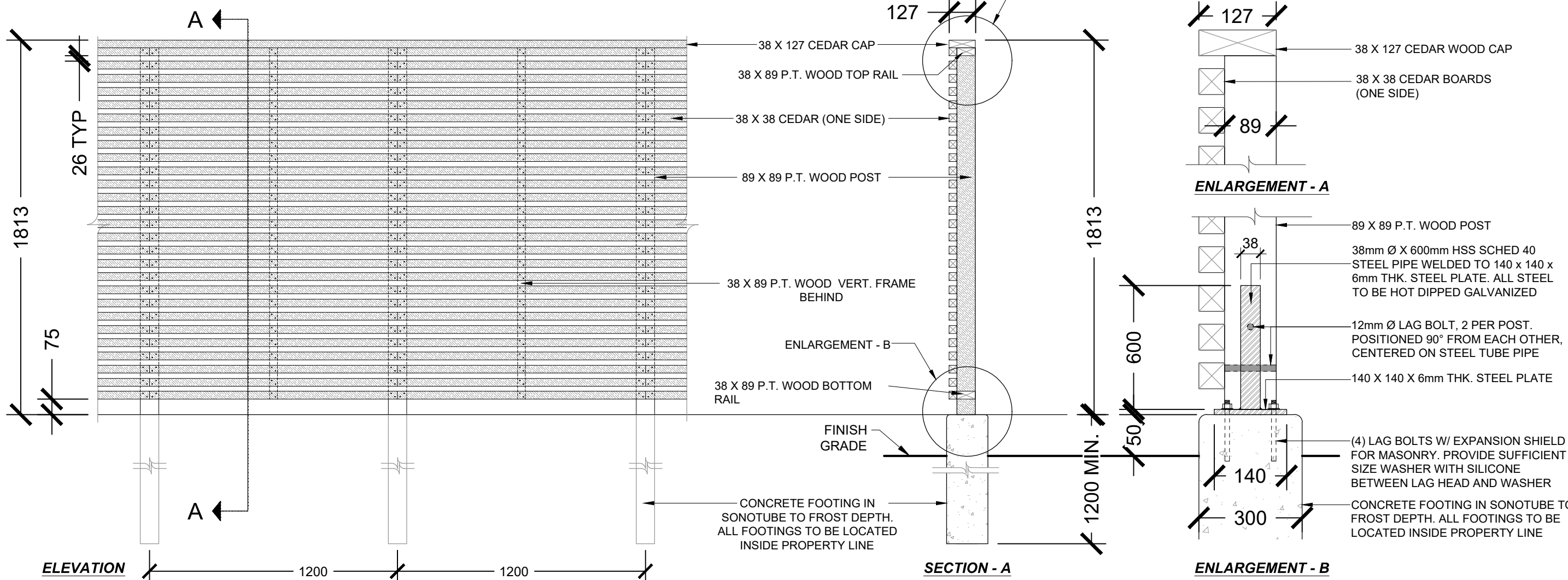
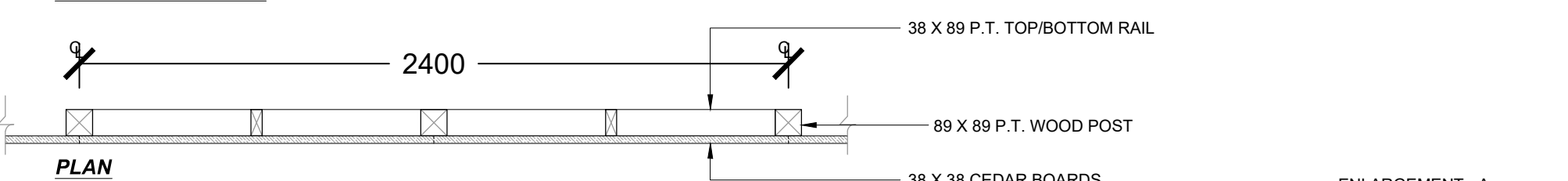
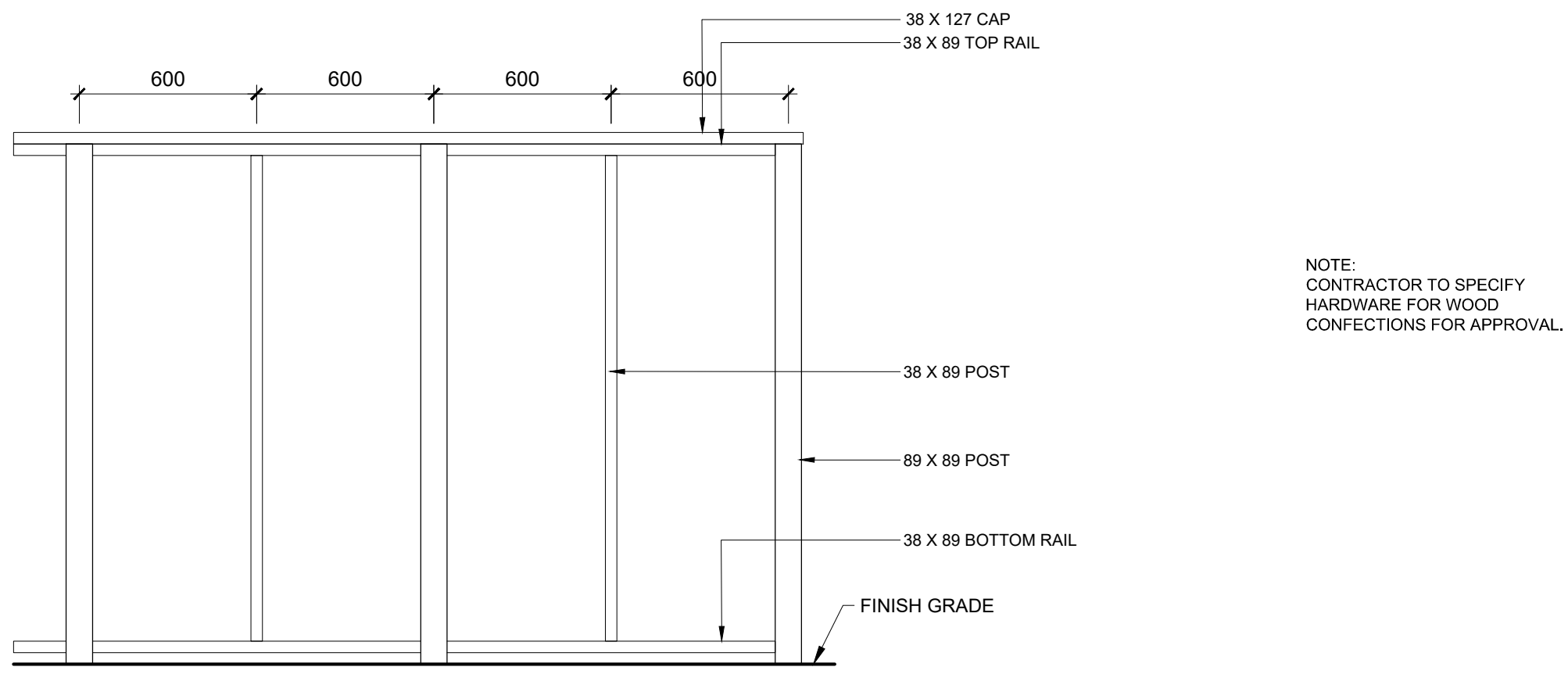

**5** WASTE BIN ENCLOSURE FRAME LAYOUT  
 1:30 P-O2-DRU-71

**6** WASTE BIN ENCLOSURE FENCE  
 1:20 P-O2-DRU-50



ISSUED FOR: LANDSCAPE ADDENDUM #1  
 DATE: 2022-02-18

REVISIONS:	NO.	DESCRIPTION	DATE	BY
	2	ISSUED LANDSCAPE ADDENDUM #1	2022-02-18	
	1	ISSUED FOR TENDER	2022-02-15	

DESIGNED BY: ZW/MW CHECKED BY: MW  
 PLOT DATE: 2022-02-15  
 DRAWING FILE NAME: LM-502 SITE FEATURES DETAILS.dwg

DRAWING TITLE:  
**SITE FURNITURE DETAILS**

**LM-502**